

## DESCRIPTIF

Menuiseries en PVC  
Gammiste : REHAU  
Gamme : S729 ARALYA  
Avis technique : 4875A-242-69

## COLORIS

Blanc teinté dans la masse

## VITRAGE

Vitrage 28 mm 4/20/4  
isolation thermique  
renforcée (ITR)  
remplissage gaz Argon  
intercalaire Warm-edge

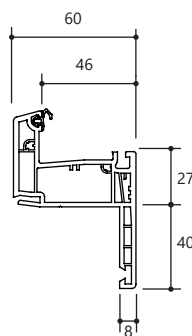
## PERFORMANCES

Étanchéité à l'air : A4  
Étanchéité à l'eau : E7A  
Résistance au vent : VA2

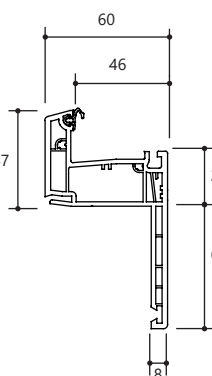
UW  
1 vantail : 1.3  
2 vantaux : 1.3

## DORMANTS

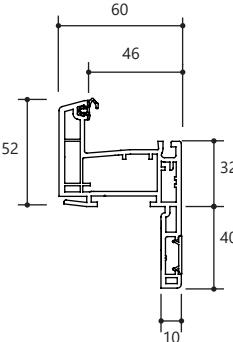
*Rénovation  
aile de 40 mm*



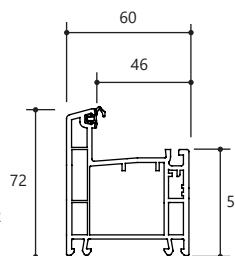
*Rénovation  
aile de 60 mm*



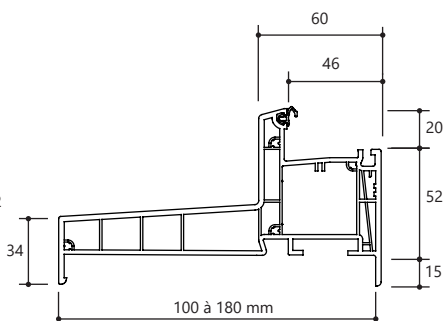
*Rénovation  
fixation façade*



*Neuf / Applique  
sans isolation*

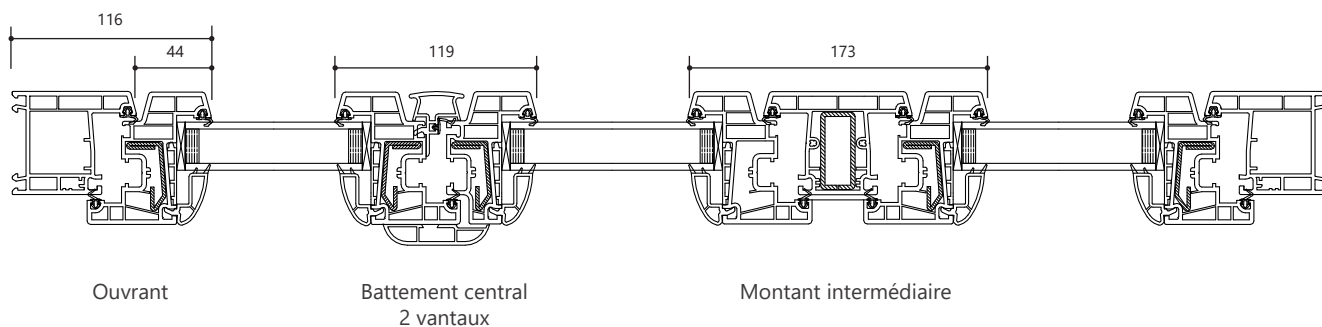


*Neuf / Applique  
avec isolation*

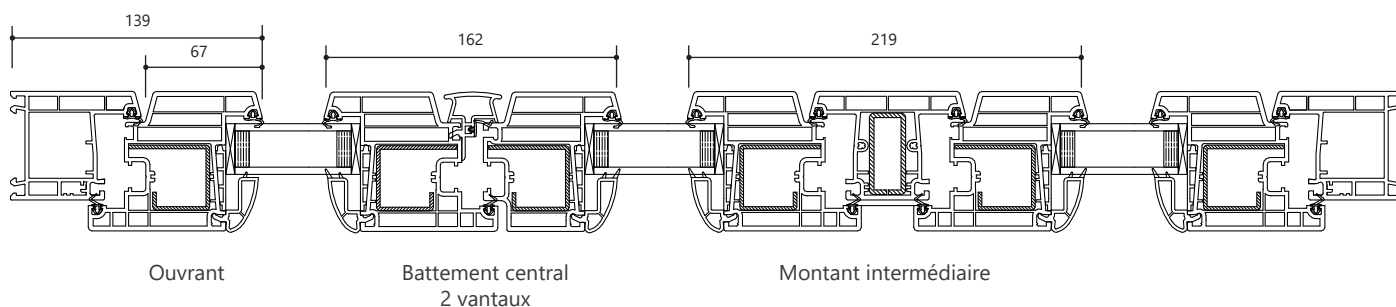


## OUVRANTS

*Fenêtre et Porte-fenêtre crémone (poignée intérieure)*



*Porte-fenêtre avec serrure à clé (poignée intérieure/extérieure)*

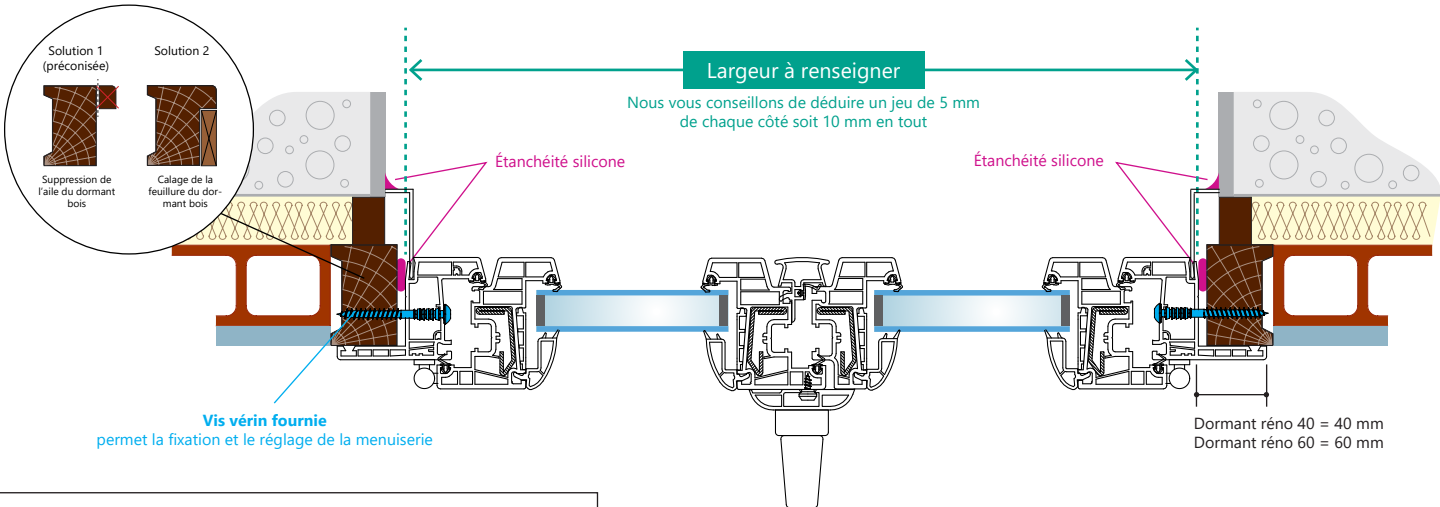


**POSE EN RÉNOVATION**  
( fixation feuillure )

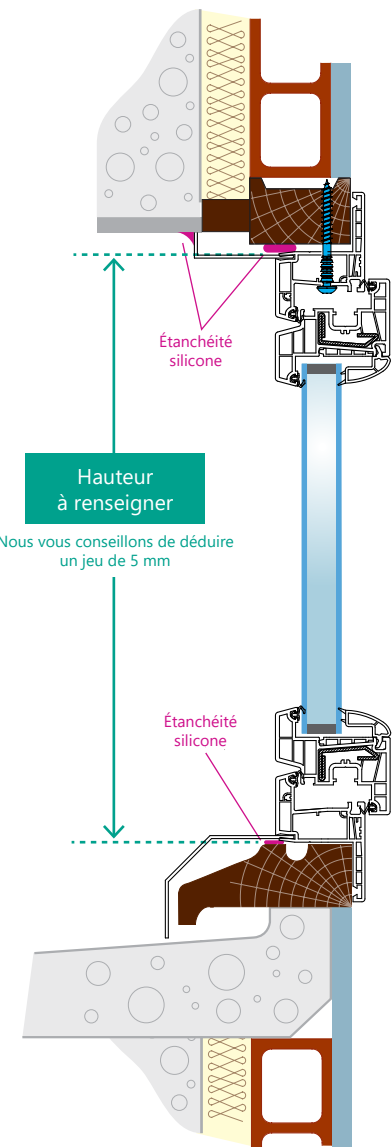
**SANS VOLET ROULANT**

V2025.02

**Fig 1. Coupe horizontale**

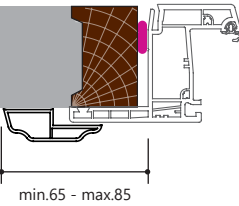


**Fig 2. Coupe verticale**

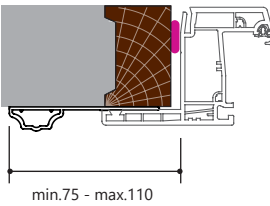


**Fig 3. Moulure(s) intérieure(s) rapportée(s) (option)**

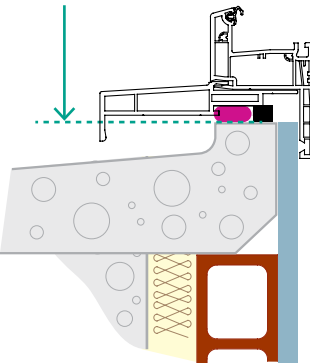
Couvre-joint N°1



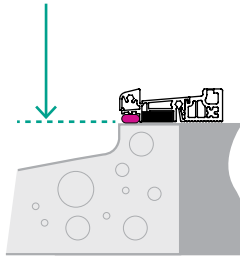
Couvre-joint N°2



**Fig 4. Variante avec suppression de l'appui en bois**



**Fig 5. Variante avec seuil en aluminium**



POSE EN RÉNOVATION  
( fixation feuillure )

VOLET ROULANT BLOC-BAIE

V2025.02

Fig 6. Coupe horizontale

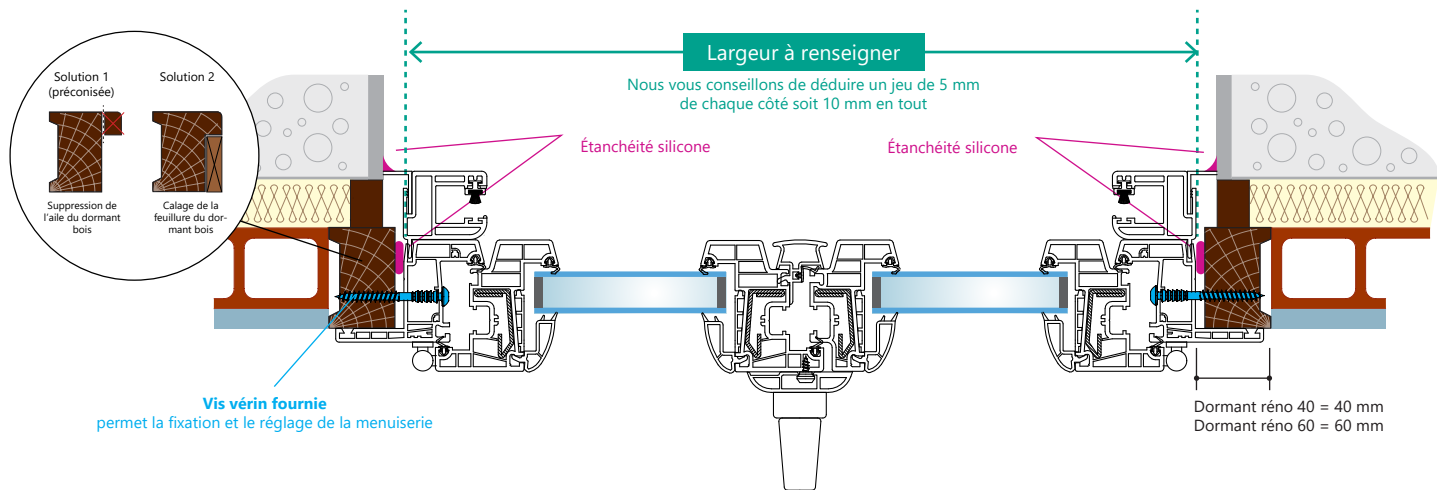


Fig 7. Coupe verticale conservation du dormant bois

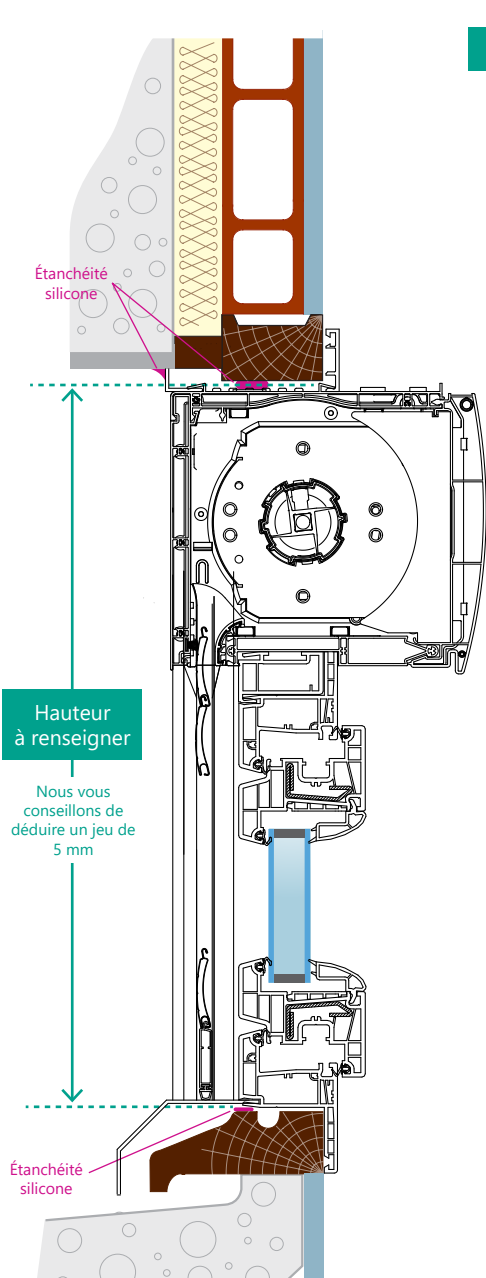


Fig 8. Coupe verticale suppression du dormant bois

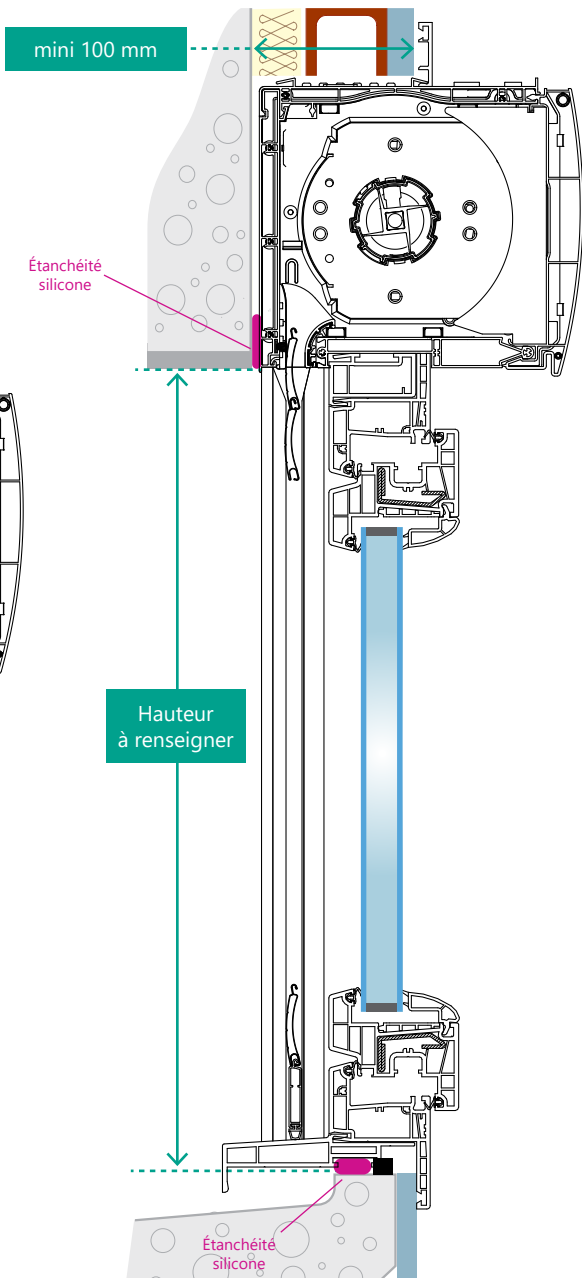


Fig 9. Moulure(s) intérieure(s) rapportée(s) (option)

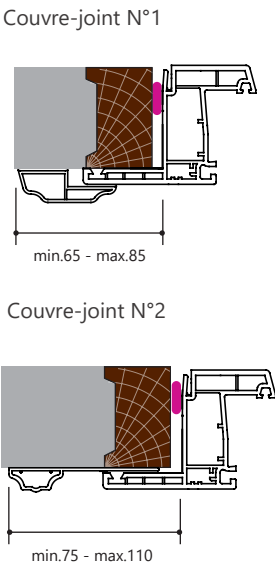
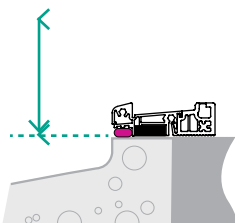
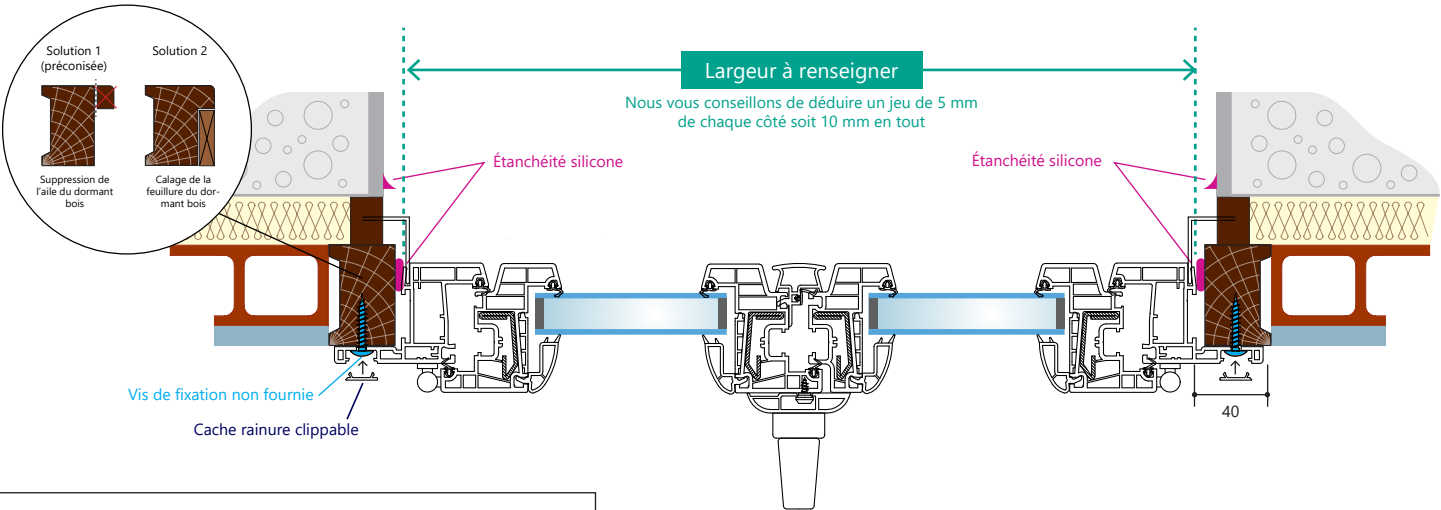


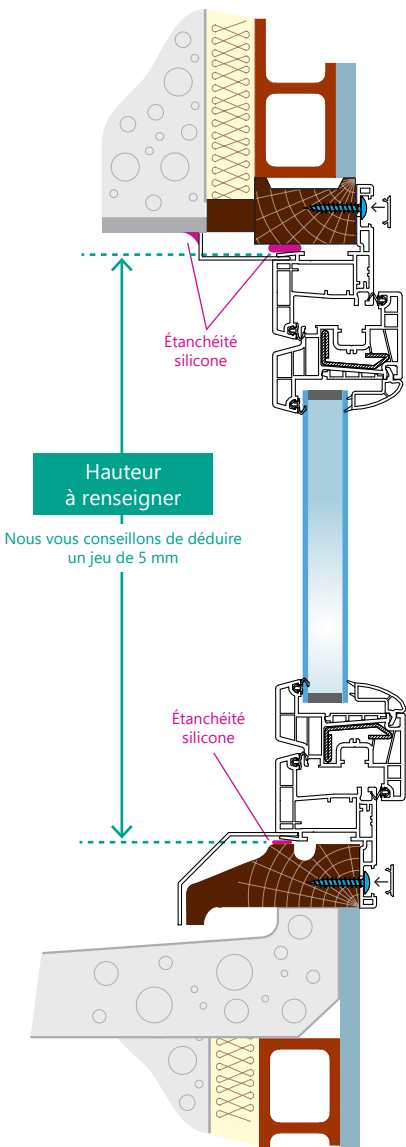
Fig 10. Variante avec seuil en aluminium



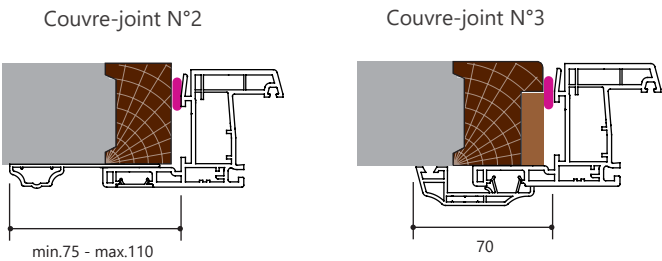
**Fig 11. Coupe horizontale**



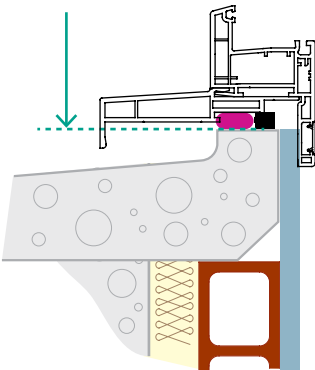
**Fig 12. Coupe verticale**



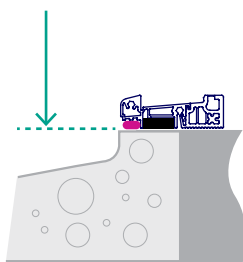
**Fig 13. Moulure(s) intérieure(s) rapportée(s) (option)**



**Fig 14. Variante avec suppression de l'appui en bois**



**Fig 15. Variante avec seuil en aluminium**



POSE EN RÉNOVATION  
( fixation façade )

VOLET ROULANT BLOC-BAIE

V2025.02

Fig 16. Coupe horizontale

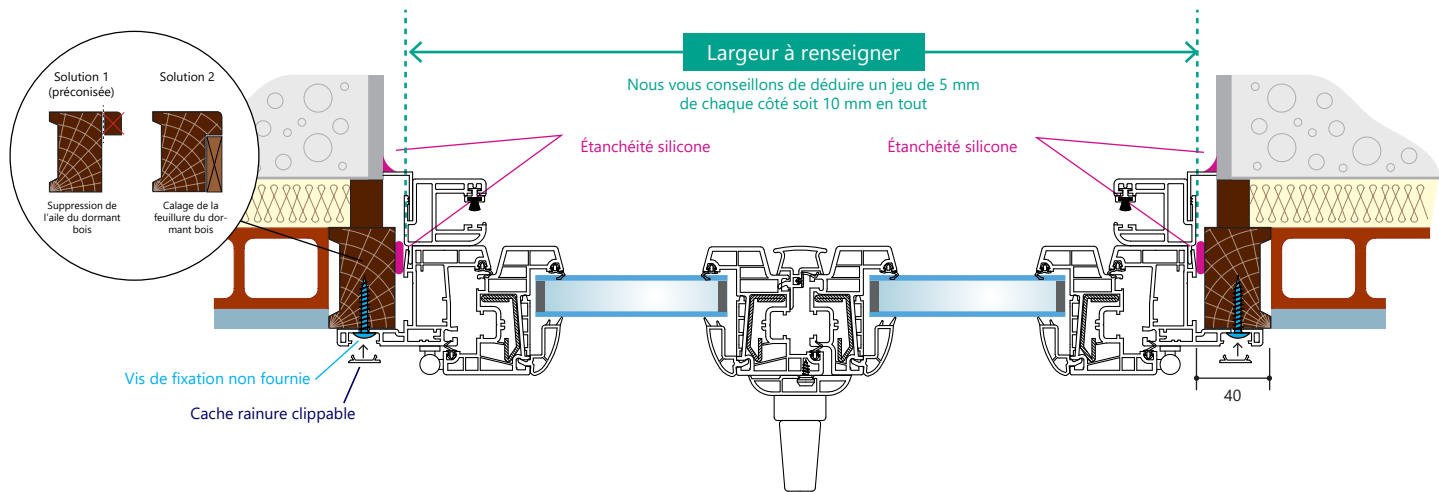


Fig 17. Coupe verticale conservation du dormant bois

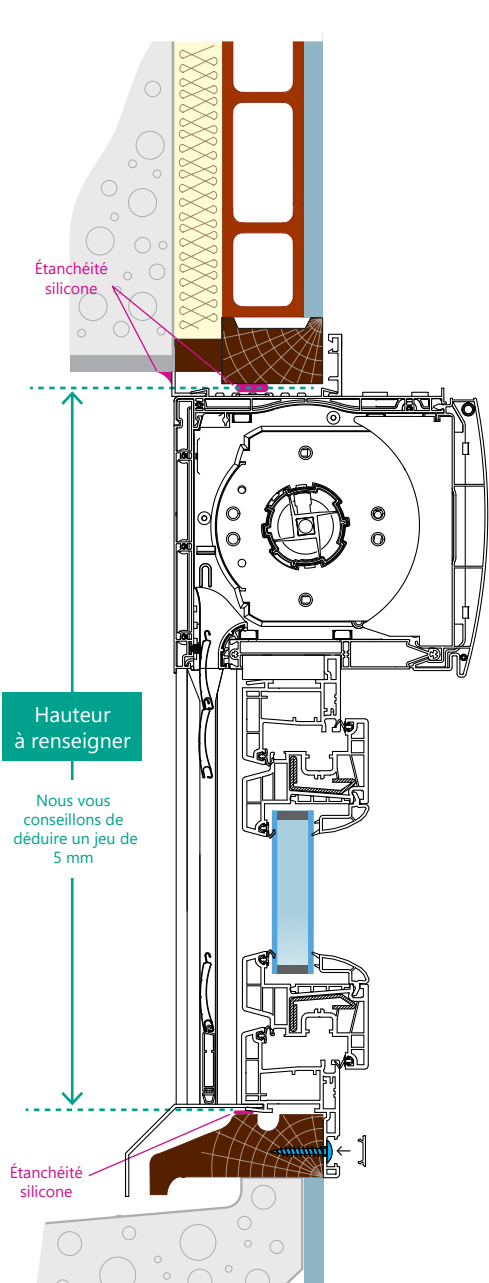


Fig 18. Coupe verticale suppression du dormant bois

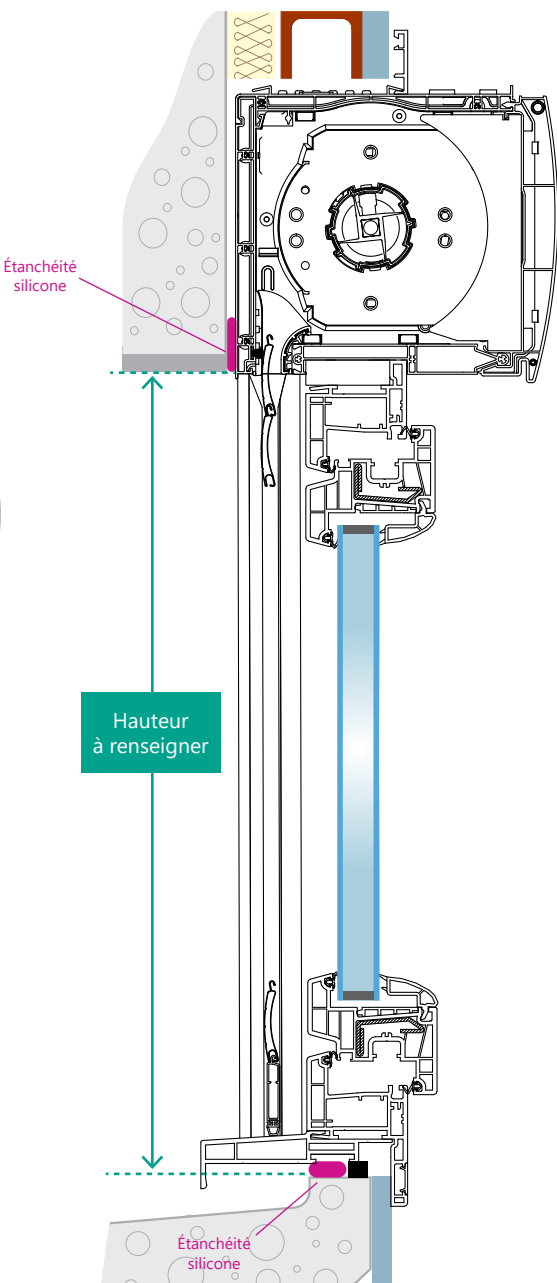


Fig 19. Moulure(s) intérieure(s) rapportée(s) (option)

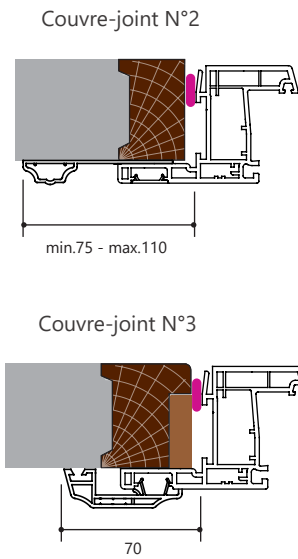
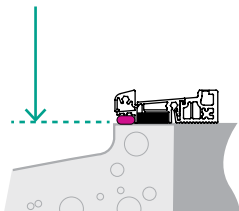
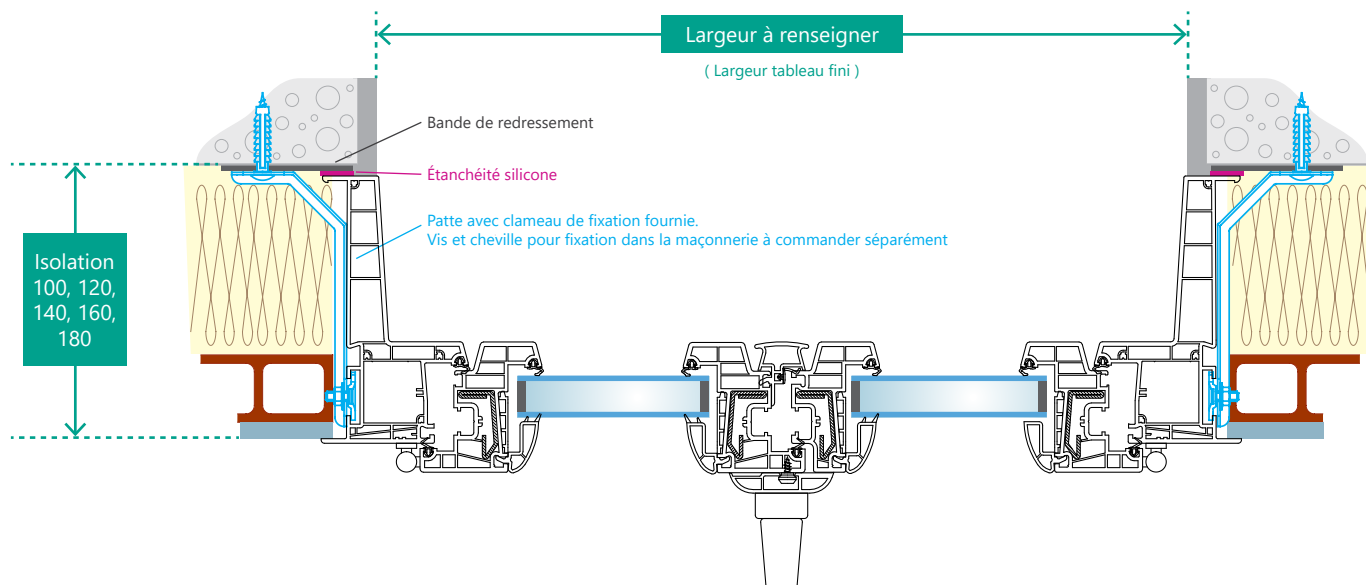


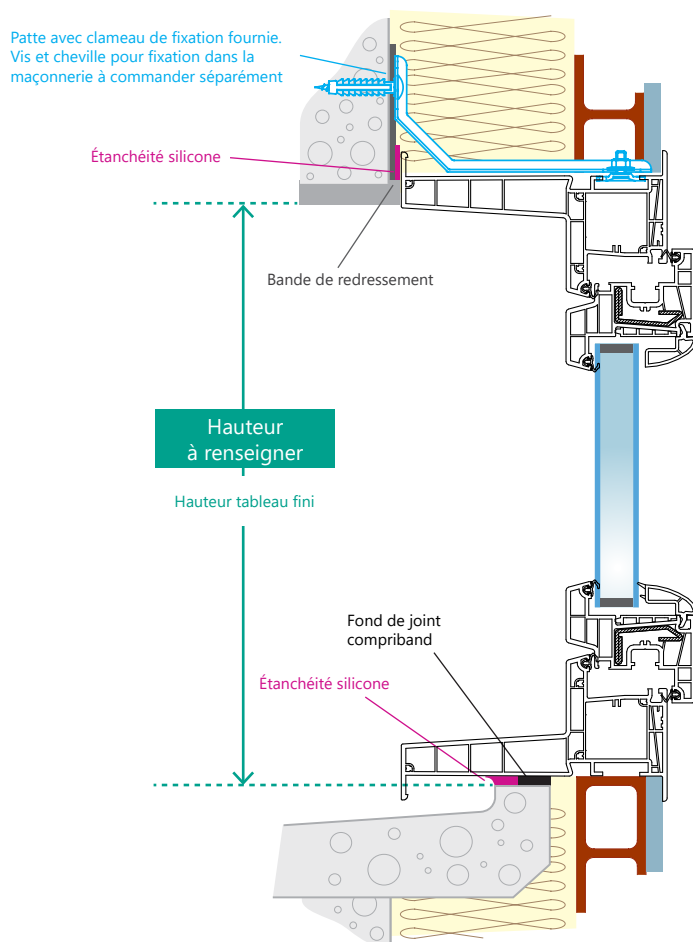
Fig 20. Variante avec seuil en aluminium



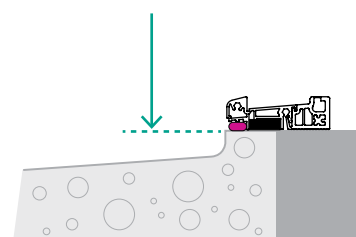
**Fig 21.** Coupe horizontale



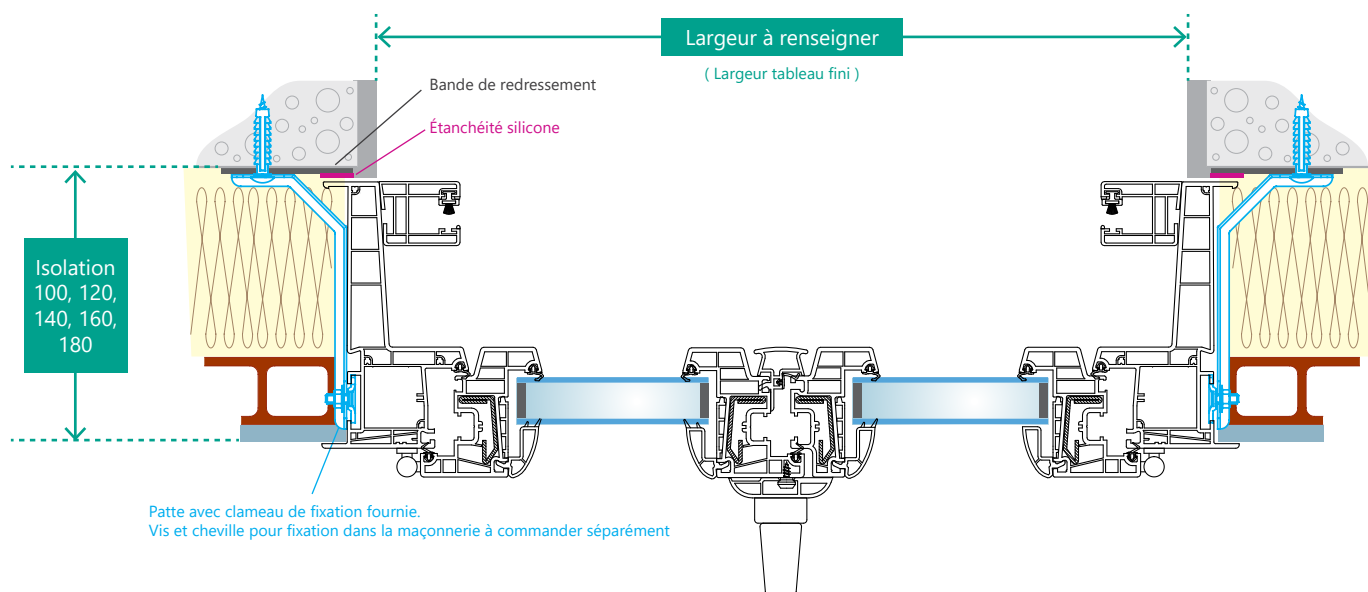
**Fig 22.** Coupe verticale



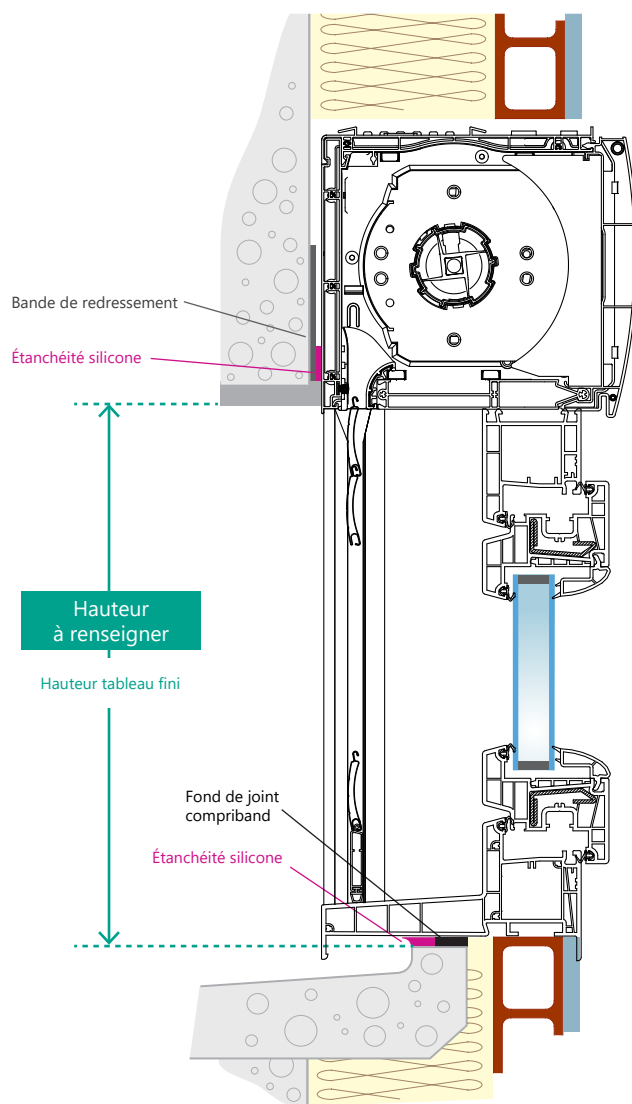
**Fig 23 . Variante avec seuil en aluminium**



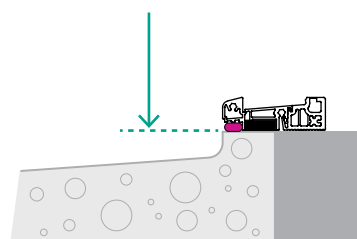
**Fig 24.** Coupe horizontale



**Fig 25.** Coupe verticale

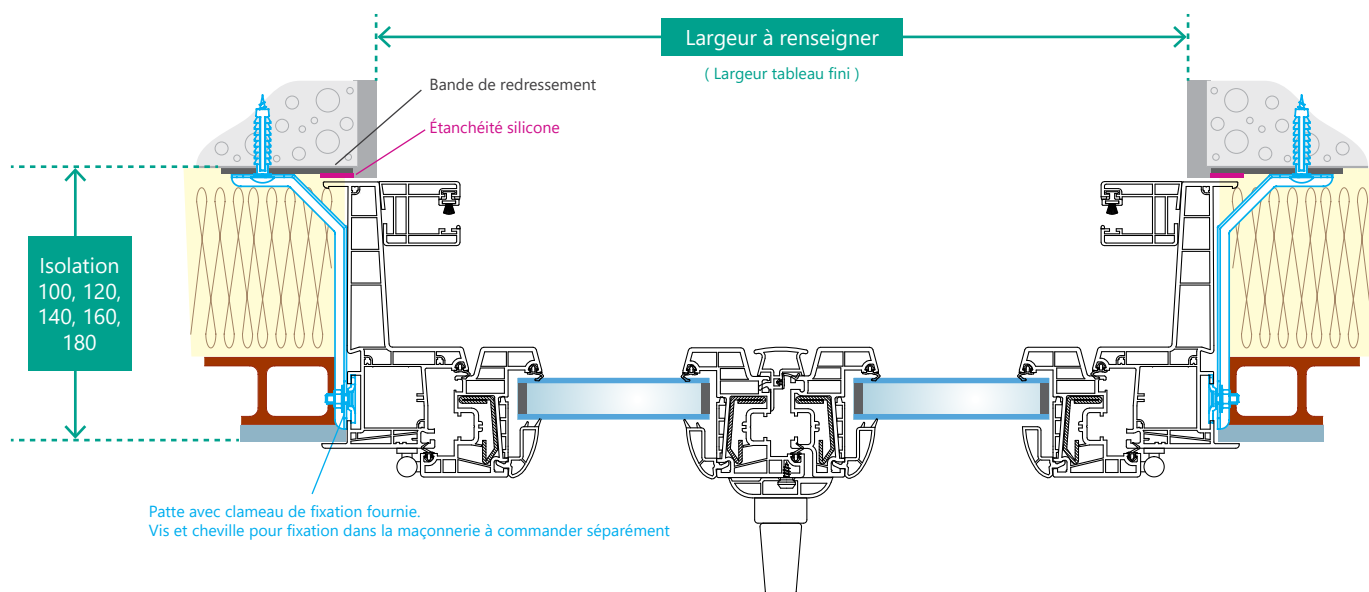


**Fig 26 . Variante avec seuil en aluminium**

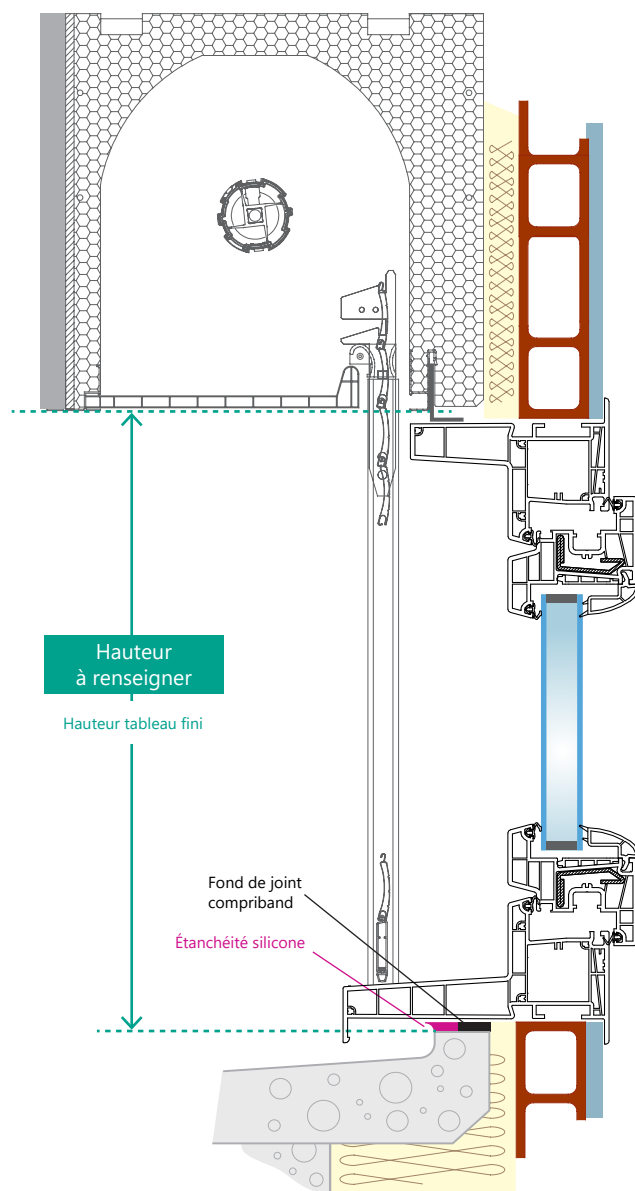




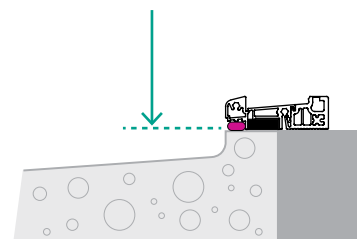
**Fig 27.** Coupe horizontale



**Fig 28.** Coupe verticale

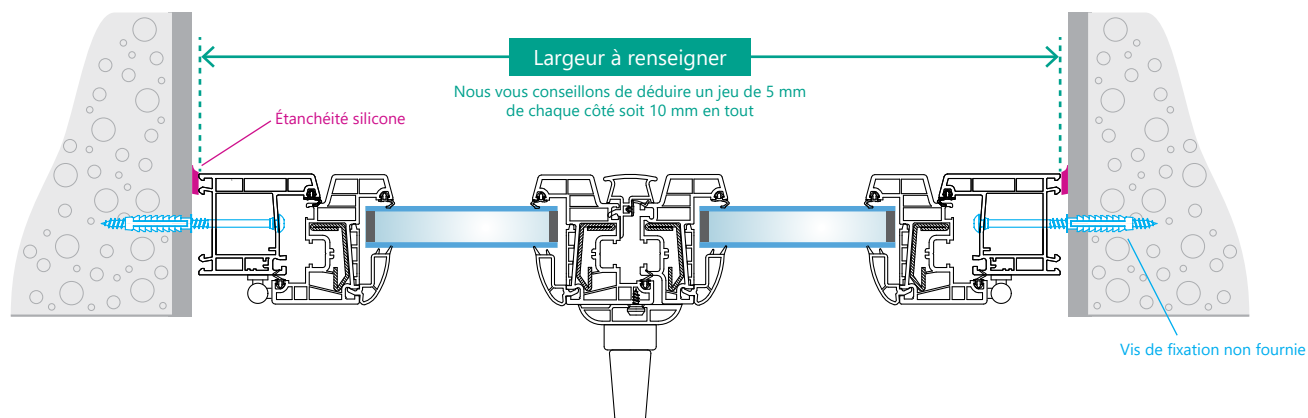


**Fig 29 . Variante avec seuil en aluminium**

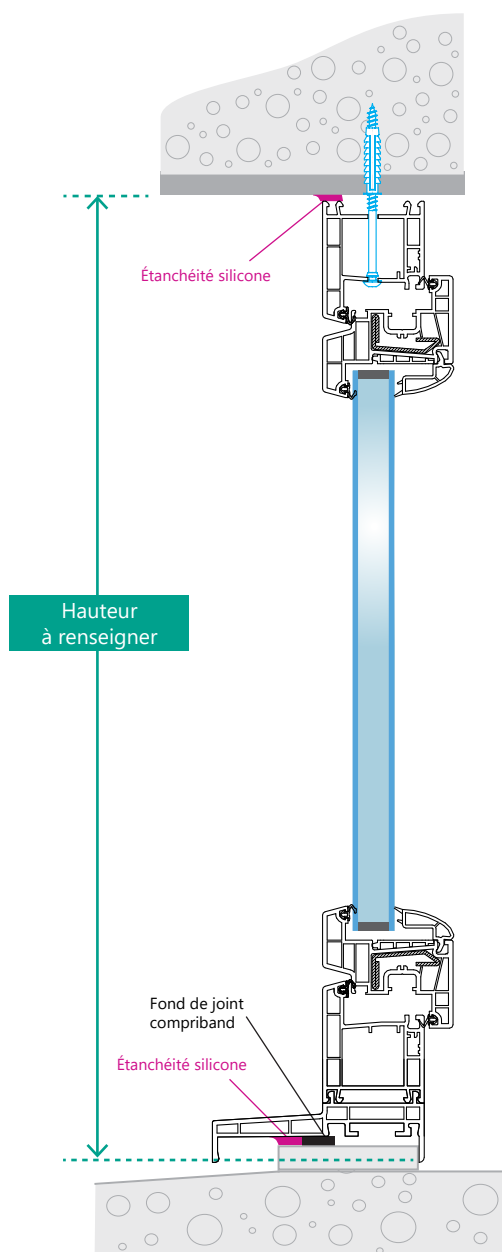




**Fig 30.** Coupe horizontale



**Fig 31.** Coupe verticale **sans volet roulant**



**Fig 32.** Coupe verticale **avec volet roulant**

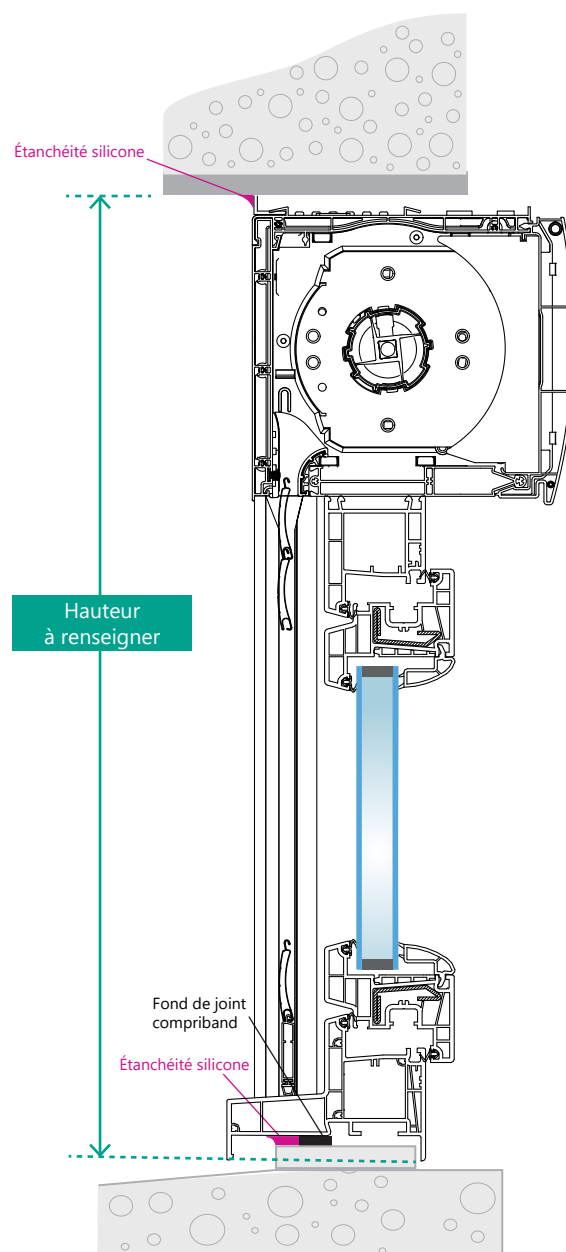


Fig 33. Coupe horizontale

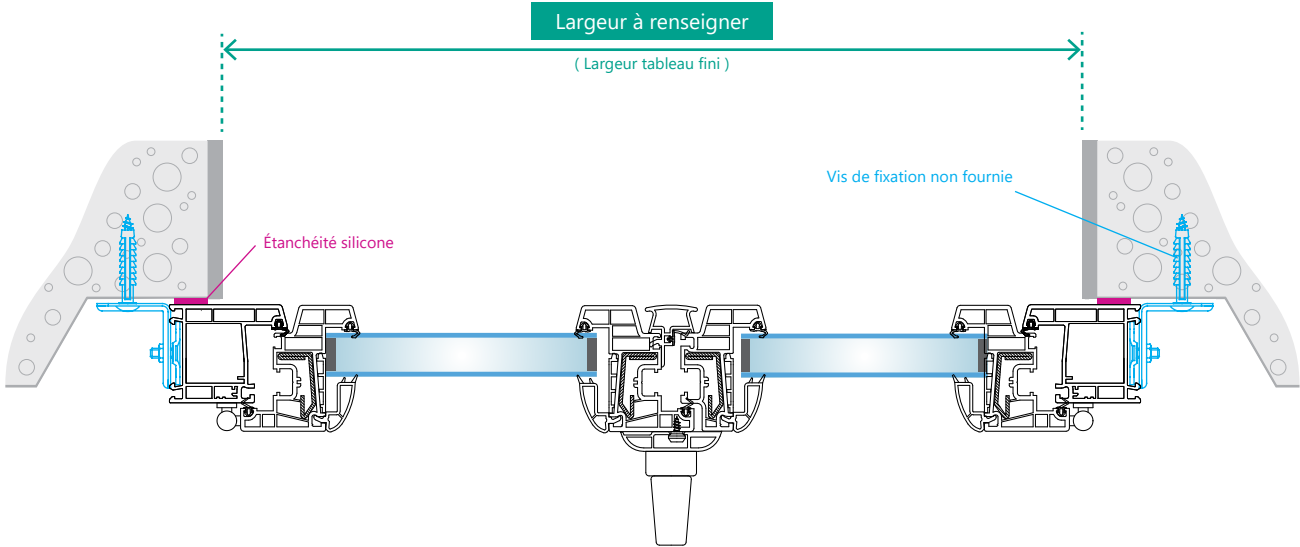


Fig 34. Coupe verticale **sans volet roulant**

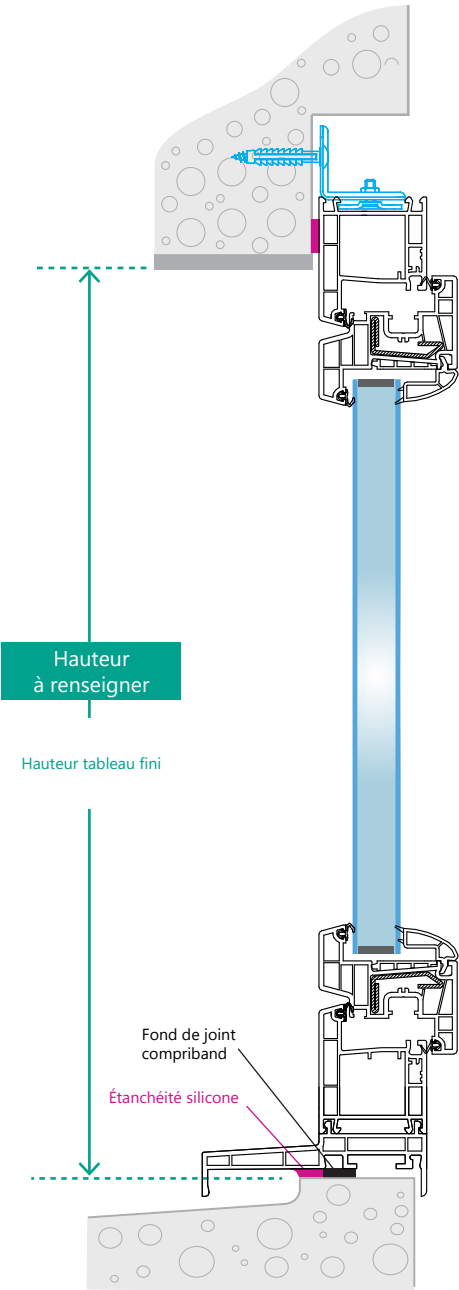


Fig 35. Coupe verticale **avec volet roulant**

